



# The Roundtable

on Religion and Social Welfare Policy

2004 Annual Conference  
December 9, 2004  
Wyndham Washington Hotel  
Washington D.C.

## 2005 and Beyond

Next Steps for Faith-Based Social Services



# 2005 and Beyond: Next Steps for Faith-Based Social Services

2004 Annual Conference: December 9, 2004 Wyndham Hotel, Washington D.C.



Richard P. Nathan  
Director  
The Nelson A. Rockefeller Institute  
and the Roundtable on Religion  
and Social Welfare Policy

## Dear Colleague:

Welcome to our nation's capital, and to the Roundtable's third annual conference. Given the prominent role that faith played in the recent election, I have no doubt that our work, and this conference, have never been more timely.

Our theme this year -- **2005 and Beyond: Next Steps for Faith-Based Social Services** -- marks an important milestone; an occasion to look back as we look forward. First and foremost, the timing of our conference provides an opportunity to assess where the Faith-Based and Community Initiative will be going over the next four years. While we anticipate that the Initiative will continue as one of the most important domestic policies of the Bush Administration, we are delighted that our main plenary session will offer a first-hand look from the Bush White House at the agenda and goals for its next term in office.

As we prepare for the Initiative's next phase, the **2004 Roundtable conference** also provides the chance to look back at how it has begun to influence the American social welfare system. We are fortunate to have many of the nation's leading researchers and scholars with us to share their important work on this issue -- both in informal discussions, and in our break-out sessions.

Our proceedings will begin on just the right note with a presentation on **The State of the Law** by Ira Lupu and Robert Tuttle, co-directors of legal research for the Roundtable and Professors of Law at George Washington University Law School. Nationally-recognized experts on the religion clauses of the First Amendment, professors Lupu and Tuttle are an indispensable resource for many of the country's leading news organizations and essential partners in the Roundtable's work. In their third annual update, they will once again offer a much-needed analysis and discussion about the current legal environment surrounding public funding of faith-based social service providers.

Our luncheon program will delve deeply into the role faith is playing in our national landscape. It will be highlighted by a panel of leading journalists who cover religion on a daily basis, and who will share their forecasts for the interesting stories that lie ahead. We are grateful for their perspectives as independent observers and for their work as "contemporary historians" of the events that shape our lives.

On behalf of my colleagues at the Roundtable and the Rockefeller Institute of Government, welcome; we are pleased you could join us, and are grateful for the support of The Pew Charitable Trusts in this work.

Best wishes for an enjoyable and informative day.

Sincerely,

Richard P. Nathan  
*Director*



# Schedule at a Glance

---

## Thursday, December 9, 2004

7:00 a.m. - 3:00 p.m.	<b>Registration Desk Open</b>	Vista Ballroom Foyer
7:00 a.m. - 5:00 p.m.	<b>Cyber Café Open</b>	Vista Ballroom Foyer
8:00 a.m. - 9:00 a.m.	<b>Continental Breakfast</b>	Vista Ballroom Foyer
9:00 a.m. - 10:45 a.m.	<b>Welcoming Remarks and Opening Plenary Session</b> "State of the Law 2004"	Vista Ballroom
10:45 a.m. - 11:00 a.m.	<b>Refreshment Break</b>	Vista Ballroom Foyer
11:00 a.m. - 12:30 p.m.	<b>Plenary Session</b> "2005 and Beyond: Next Steps for Faith-Based Social Services"	Vista Ballroom
1:00 p.m. - 2:30 p.m.	<b>Luncheon with Media Panel Discussion:</b> "The Public View of Faith"	Vista Ballroom
2:45 - 4:15 p.m.	<b>Breakout Sessions</b>	
	<b>"The Promise and Performance of Faith-Based Social Services"</b>	Vista Ballroom A
	<b>"Trends and Challenges: State Partnerships with Faith-Based Service Providers"</b>	Ashlawn South
	<b>"The Mission and the Money: Exploring Tensions between the Privileges and Obligations of Religious Organizations in Civil Society"</b>	Ashlawn North
4:15 p.m.	<b>Conference concludes</b>	

# Agenda

## Thursday, December 9, 2004

### 7:00 a.m. - 3:00 p.m. Registration Desk Open

VISTA BALLROOM FOYER

### 7:00 a.m. - 5:00 p.m. Cyber Café

VISTA BALLROOM FOYER

Stop by to stay in touch with the office or family -- send or check e-mail

### 8:00 a.m. - 9:00 a.m. Continental Breakfast

VISTA BALLROOM FOYER

### 9:00 a.m. - 10:45 a.m. Welcome and Opening Remarks

VISTA BALLROOM

Richard P. Nathan, Director,  
Rockefeller Institute of Government

#### Opening Plenary Session

##### "State of the Law 2004"

The Roundtable will present its third annual update on the legal environment affecting federal and state government partnerships with faith-based social service providers. This session will report on 2004's most important judicial decisions and highlight significant cases that are pending. Presentations will analyze Executive Branch actions and developments in state constitutional law, with discussion taking up the importance of recent elections for the law regarding faith-based social services.

- ◆ Ira "Chip" Lupu, Professor, The George Washington University Law School, Co-Director of the Legal Tracking Project of the Roundtable on Religion and Social Welfare Policy
- ◆ Robert Tuttle, Professor, The George Washington University Law School, Co-Director of the Legal Tracking Project of the Roundtable on Religion and Social Welfare Policy

### 10:45 a.m. - 11:00 a.m. Refreshment Break

VISTA BALLROOM FOYER

### 11:00 a.m. - 12:30 p.m. Plenary Session

VISTA BALLROOM

#### "2005 and Beyond: Next Steps for Faith-Based Social Services"

Matters of faith were pivotal in the reelection of President Bush, and faith-based social services are likely to continue to be an important part of the Administration's policy agenda. Questions are raised about the future: Will the Faith-Based and Community Initiative's scope and scale remain the same -- or will it be expanded? Will this effort continue to rely mostly on administrative actions in Washington, or will it involve legislation and state action? We will hear first-hand from the Bush administration on its future strategy for the Initiative and from key policy makers on all sides of the issue.



## 11:00 a.m. - 12:30 p.m. continued

VISTA BALLROOM

- ◆ James Towey, White House Deputy Assistant to the President and Director, Office of Faith-Based and Community Initiatives
- ◆ Representative Chet Edwards, D-Texas
- ◆ Stanley Carlson-Thies, Director of Social Policy Studies, The Center for Public Justice
- ◆ Chris Anders, Legislative Counsel, ACLU

## 1:00 p.m. - 2:30 p.m.

VISTA BALLROOM

### Luncheon

#### Panel discussion: "The Public View of Faith"

Whether and how governments might partner with faith-based social service providers has been a contentious issue over the past four years. And, following the election, its prominence is expected to continue as our country searches for new ways to better serve its neediest citizens in the years ahead. A distinguished panel of journalists will discuss the prospects for faith-based services, trends in political involvement of religious groups, and share their forecast for interesting stories to watch in the years ahead.

- ◆ Jason DeParle, Senior Writer, The New York Times
- ◆ Barbara Bradley Hagerty, Religion Correspondent, National Public Radio
- ◆ Adelle M. Banks, Senior Correspondent, Religion News Service
- ◆ Alan Cooperman, Religion Correspondent, Washington Post

## 2:45 - 4:15 p.m.

VISTA BALLROOM A

### Breakout Sessions

#### "The Promise and Performance of Faith-Based Social Services"

For all the interest in the topic, and all the anecdotal stories of accomplishment by individuals and individual organizations, there remains little systematic evidence of the extent, character and particularly the comparative effectiveness of faith-based social service providers. Three researchers discuss new findings and work underway concerning the scope and performance of faith-based social services.

- ◆ Stephen Monsma, Research Fellow, Henry Institute for Study of Christianity and Politics, Calvin College and Fellow, The Center for Public Justice
- ◆ Mark Ragan, Senior Fellow, Rockefeller Institute of Government
- ◆ David Campbell, Cooperative Extension Specialist and Director of the California Communities Program (CCP), Human and Community Development Department, University of California, Davis.



# Agenda

## ASHLAWN SOUTH

### **"Trends and Challenges: State Partnerships with Faith-Based Service Providers"**

The Faith-Based and Community Initiative has drawn considerable attention in Washington. But because state and local governments make so many of the decisions about social service contracting in America, much of what affects the potential for government partnerships with faith-based social service providers is happening out in state capitols and town halls. This session will share new research on state contracting for services under TANF, and on fiscal and programmatic trends affecting the availability of public funding for new service partnerships with religiously-affiliated or other groups.

- ◆ Courtney Burke, Senior Research Scientist, Rockefeller Institute of Government
- ◆ Thomas Gais, Director, Federalism Research Group, Rockefeller Institute of Government
- ◆ John Jacobson, Senior Economist, Mathematica Policy Research, Inc.

## ASHLAWN NORTH

### **"The Mission and the Money: Exploring Tensions between the Privileges and Obligations of Religious Organizations in Civil Society"**

Challenges by religious people and organizations to what they have viewed as immoral or unjust government policies have been the hallmark of the "prophetic tradition," and have been seen by many as an important and valuable function of religion in civil society. Some of the first concerns raised about government funding of religious service organizations centered on worries that they would lose or mute their "prophetic voice" if they took government money. The panel will consider whether social advocacy should be seen as an activity worthy of social subsidy, and will discuss what evidence there is about whether, and in what ways, religious organizations encounter situations of conflict; where standing for certain causes or values brings them into conflict with the state.

- ◆ Thomas Jeavons, General Secretary, Philadelphia Yearly Meeting
- ◆ Mark Chaves, Professor, University of Arizona
- ◆ Heidi Unruh, Associate Director of the Congregations, Community Outreach and Leadership Development Project, Eastern Seminary, and Policy Analyst, Evangelicals for Social Action

4:15 p.m.

**Conference concludes**



**CONFERENCE/MEETING ROOMS**

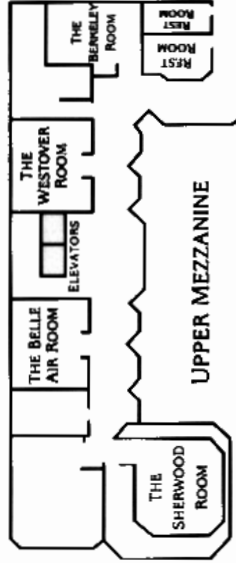
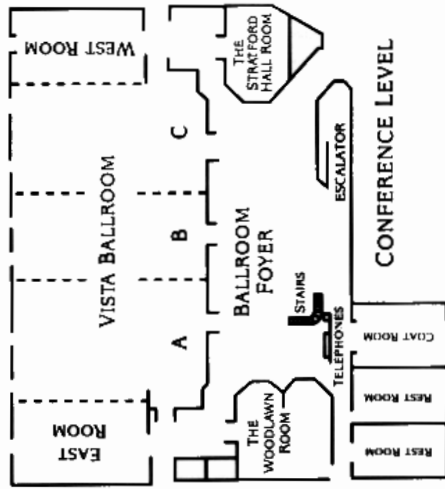
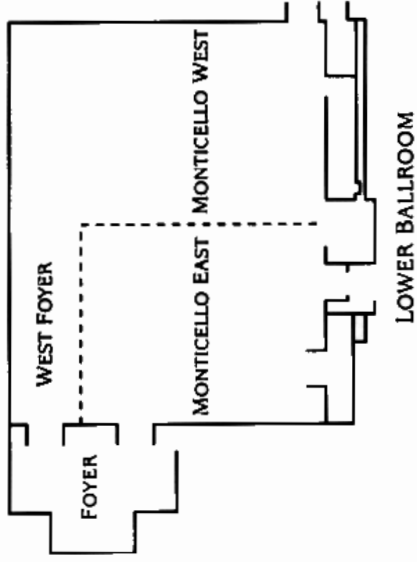
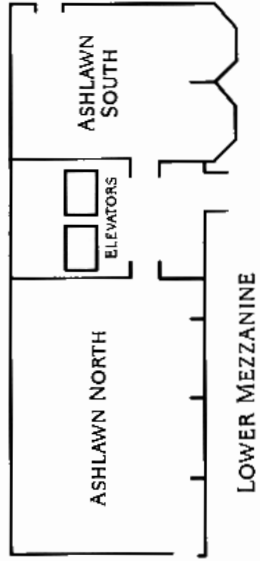

**WYNDHAM WASHINGTON, D.C.<sup>SM</sup>**



**The Roundtable on Religion and Social Welfare Policy**

[www.ReligionandSocialPolicy.org](http://www.ReligionandSocialPolicy.org)

(518) 443-5014



**The Nelson A. Rockefeller  
Institute of Government**  
State University of New York  
411 State Street  
Albany, NY12203

---

---

THE GEORGE  
WASHINGTON  
UNIVERSITY  
LAW SCHOOL

---

---

WASHINGTON DC